

05/20/16

CONTRACT NO.: DA00180 WBS ELEMENT: ICR.10721.6, ETC.

STATE OF NORTH CAROLINA
DIVISION OF HIGHWAYS

PERQUIMANS COUNTY

LOCATION: MAP 1 NC 37 FROM US 17 BUSINESS TO WINFALL
 MAP 2 NC 37 FROM BEGIN C & G END OF C & G
 MAP 3 NC 37 FROM END C & G TO CHOWAN COUNTY LINE
 MAP 4 SR 1334 (HOG NECK RD.) FROM SR 1329 TO SR 1365
 TYPE OF WORK: RESURFACING & PAVEMENT MARKINGS

STATE	STATE PROJECT REFERENCE NO.	SHEET NO.	TOTAL SHEETS
N.C.	1CR.10721.6, ETC.	1	10
STATE PROJ. NO.	F.A. PROJ. NO.	DESCRIPTION	
1CR.10721.6		MAP 1	
1CR.10721.7		MAP 2	
1CR.10721.8		MAP 3	
1CR.20721.29		MAP 4	

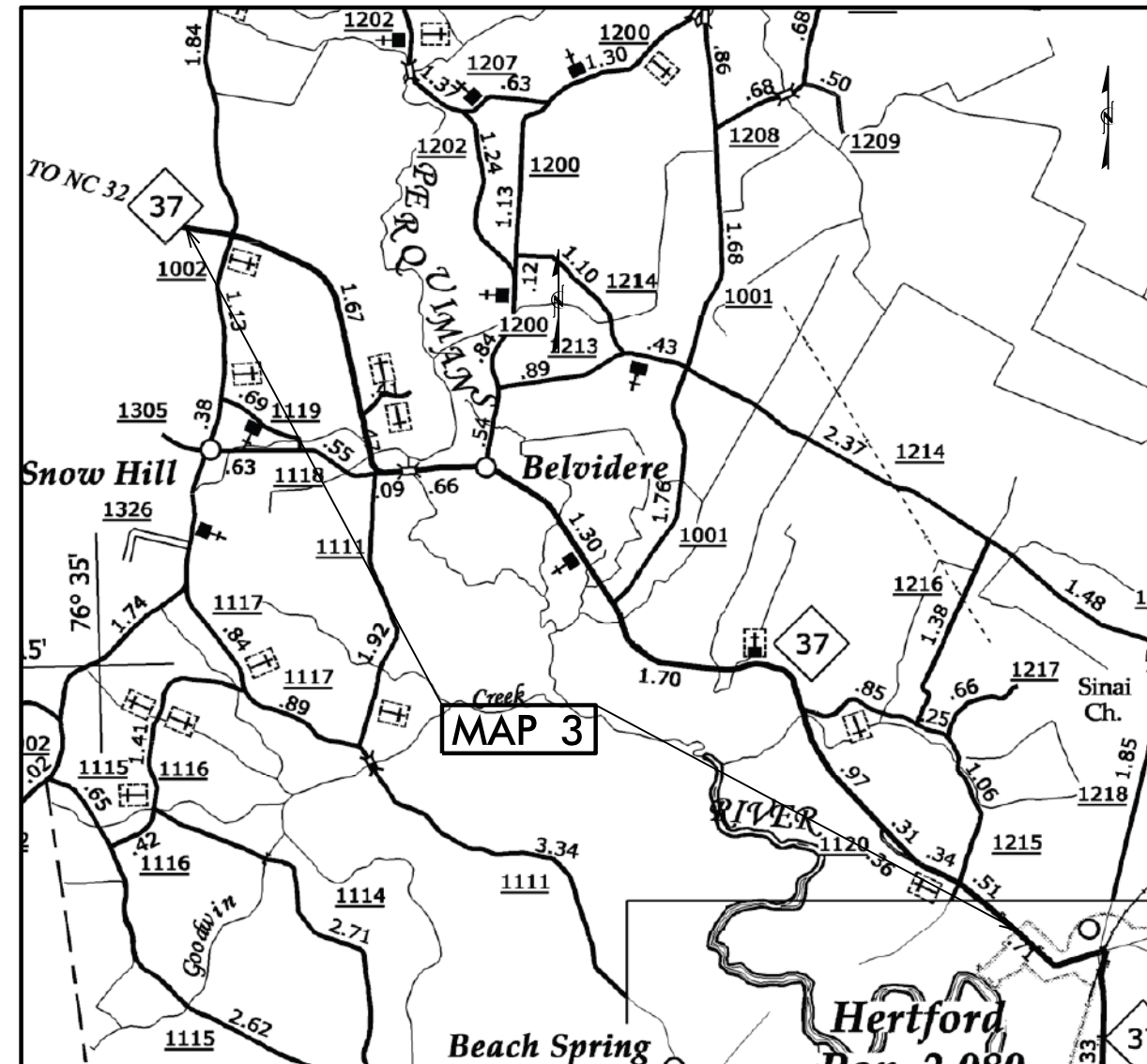
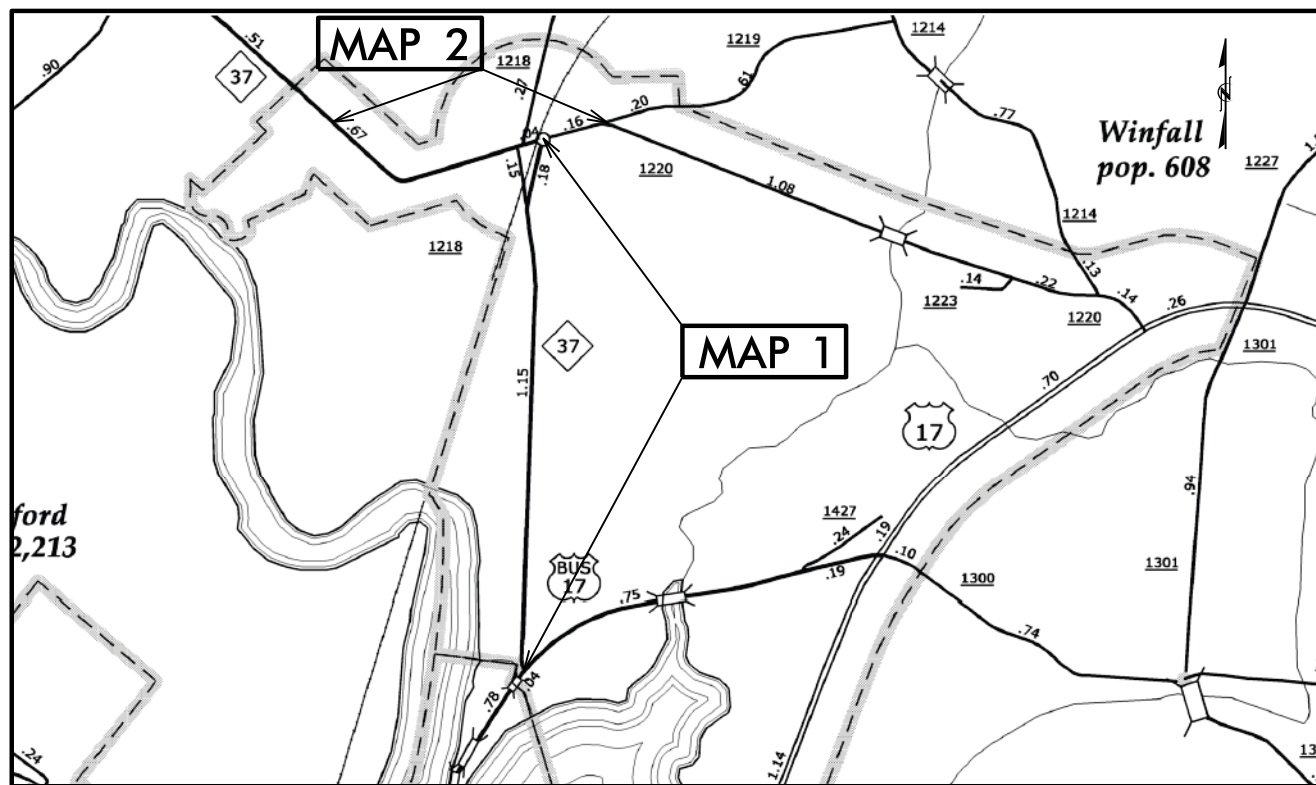
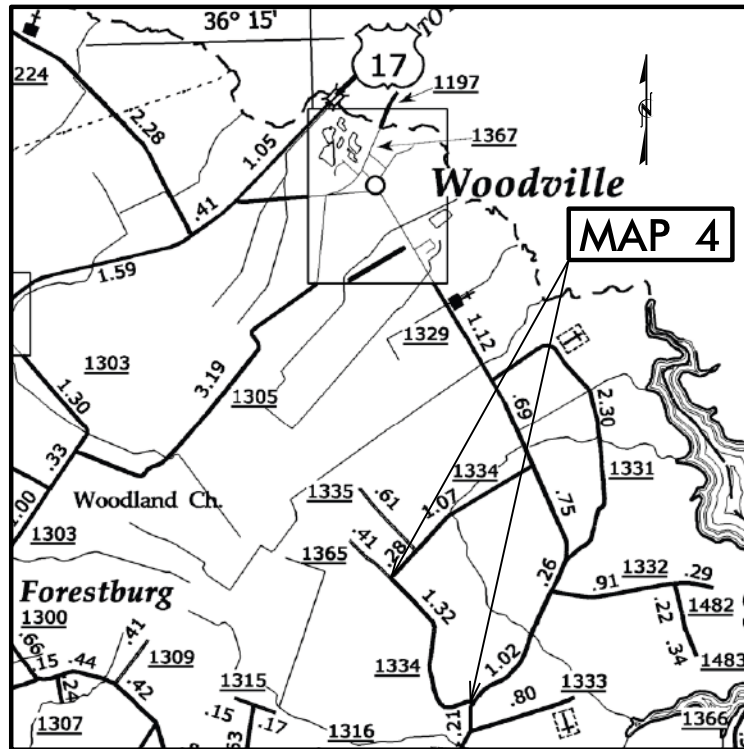

NTS

PROJECT LENGTH	
LENGTH OF ROADWAY PROJECT MAP 1 =	1.33 MI.
LENGTH OF ROADWAY PROJECT MAP 2 =	0.59 MI.
LENGTH OF ROADWAY PROJECT MAP 3 =	8.23 MI.
LENGTH OF ROADWAY PROJECT MAP 4 =	1.35 MI.

Prepared in the Office of:
DIVISION OF HIGHWAYS
 113 Airport Dr., Edenton NC, 27932

2012 STANDARD SPECIFICATIONS

LETTING DATE: _____

W. B. HOBBS, P.E.
 DIVISION PROJECT MANAGER

C. E. SLACHTA
 DIVISION PROPOSALS ENGINEER

DIVISION OF HIGHWAYS
 STATE OF NORTH CAROLINA

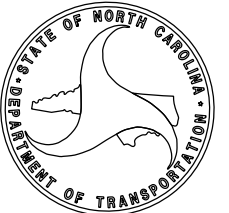

05/20/16

CONTRACT NO.: DA00180 WBS ELEMENT: ICR.10721.6, ETC.

STATE OF NORTH CAROLINA
DIVISION OF HIGHWAYS

PERQUIMANS COUNTY

STATE	STATE PROJECT REFERENCE NO.	SHEET NO.	TOTAL SHEETS
N.C.	ICR.10721.6,ETC.	2	10
STATE PROJ. NO.	F.A. PROJ. NO.	DESCRIPTION	
ICR.20721.32		MAP 5	
ICR.20721.33		MAP 6	
ICR.20721.34		MAP 7	
ICR.20721.35		MAP 8	
ICR.20721.36		MAP 9	
ICR.20721.37		MAP 10	

LOCATION: MAP 5 SR 1339 (PENDER RD.) FROM SR 1336 TO SR 1340
 MAP 6 SR 1341 (BURNT MILL RD.) FROM SR 1340 TO SR 1342
 MAP 7 SR 1356 (BETHEL FISHING CENTER RD.) FROM SR 1340 TO END OF MAINTENANCE
 MAP 8 SR 1370 (OLIVER RD.) FROM SR 1356 TO SR 1415
 MAP 9 SR 1415 (HAPPY LN.) FROM SR 1370 TO DEAD END
 MAP 10 SR 1412 (GOOSIE LN.) FROM SR 1370 TO SR 1370
TYPE OF WORK: RESURFACING & PAVEMENT MARKINGS

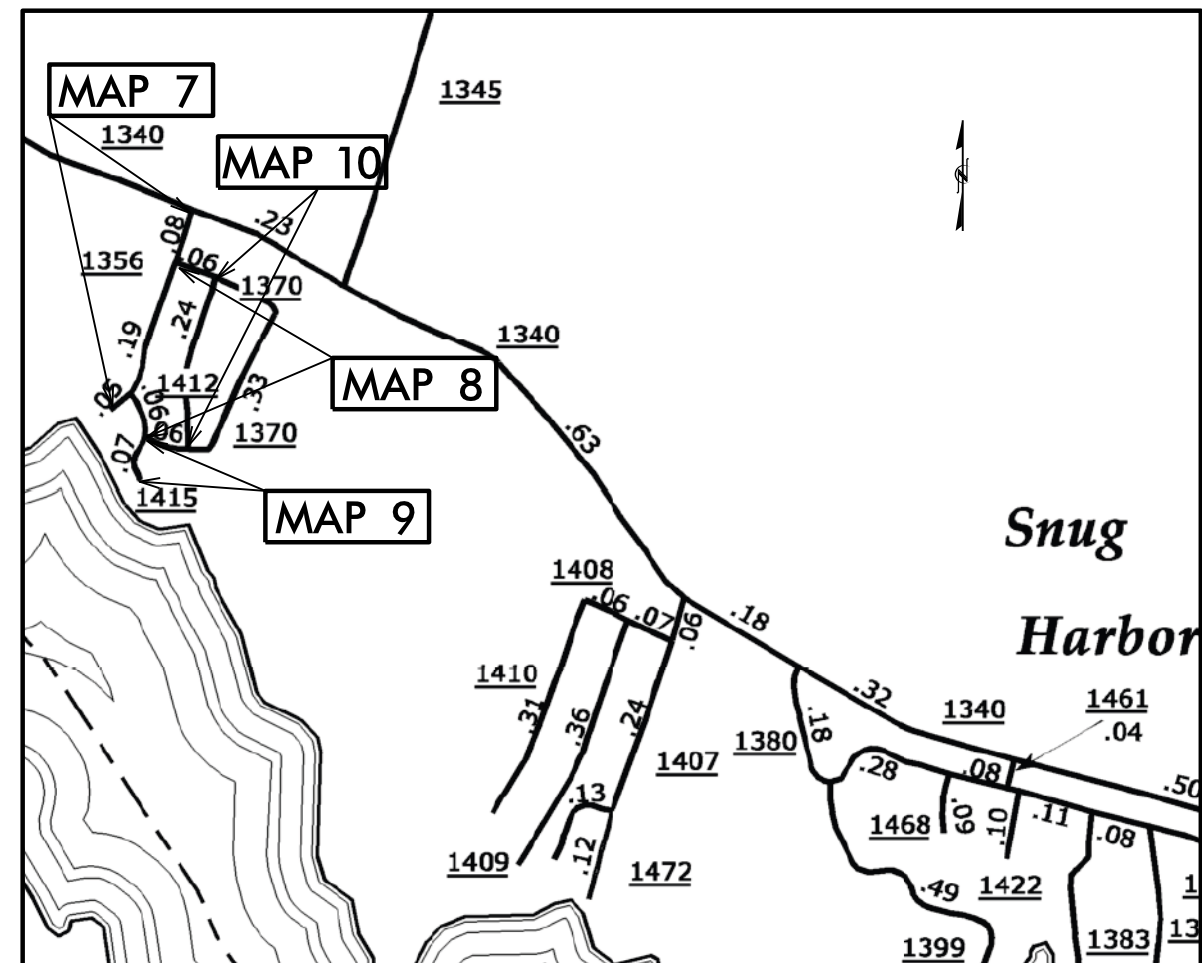
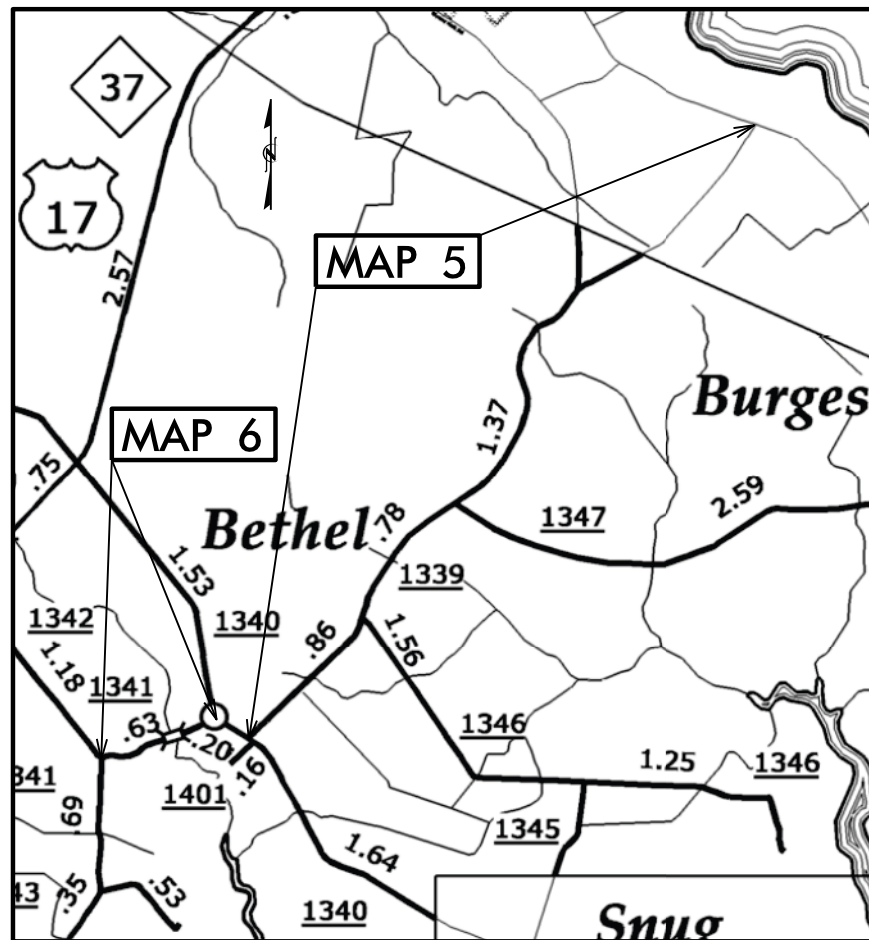

NTS

PROJECT LENGTH
LENGTH OF ROADWAY PROJECT MAP 5 = 4.25 MI.
LENGTH OF ROADWAY PROJECT MAP 6 = 0.59 MI.
LENGTH OF ROADWAY PROJECT MAP 7 = 0.31 MI.
LENGTH OF ROADWAY PROJECT MAP 8 = 0.50 MI.
LENGTH OF ROADWAY PROJECT MAP 9 = 0.07 MI.
LENGTH OF ROADWAY PROJECT MAP 10 = 0.24 MI.

Prepared in the Office of:
DIVISION OF HIGHWAYS
 113 Airport Dr., Edenton NC, 27932

2012 STANDARD SPECIFICATIONS

LETTING DATE: _____

W.B. HOBBS, P.E.
 DIVISION PROJECT MANAGER

C.E. SLACHTA
 DIVISION PROPOSALS ENGINEER

DIVISION OF HIGHWAYS
 STATE OF NORTH CAROLINA

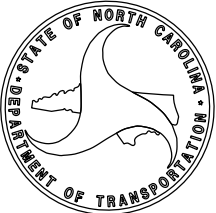

PAVEMENT SCHEDULE

C1	PROP. APPROX. 1.5" ASPHALT CONCRETE SURFACE COURSE, TYPE S9.5B, AT AN AVERAGE RATE OF 168 LBS. PER SQ. YD.
U	EXISTING PAVEMENT.

PROJECT REFERENCE NO.	SHEET NO.
1CR.10721.6 , ETC.	4

NOTES:

- *ALL PAVED S.R. ROADS TO BE RESURFACED TO THE ENDS OF THE RADI., OR AS DIRECTED BY THE ENGINEER
- *EDGES, PAVEMENT WIDENING, INTERSECTIONS, AND BRIDGE FLARES ARE INCLUDED IN THE TABLE OF QUANTITIES
- *PAVEMENT EDGE SLOPES ARE 1:1 UNLESS SHOWN OTHERWISE
- *SHOULDERS TO BE RECONSTRUCTED BY OTHERS

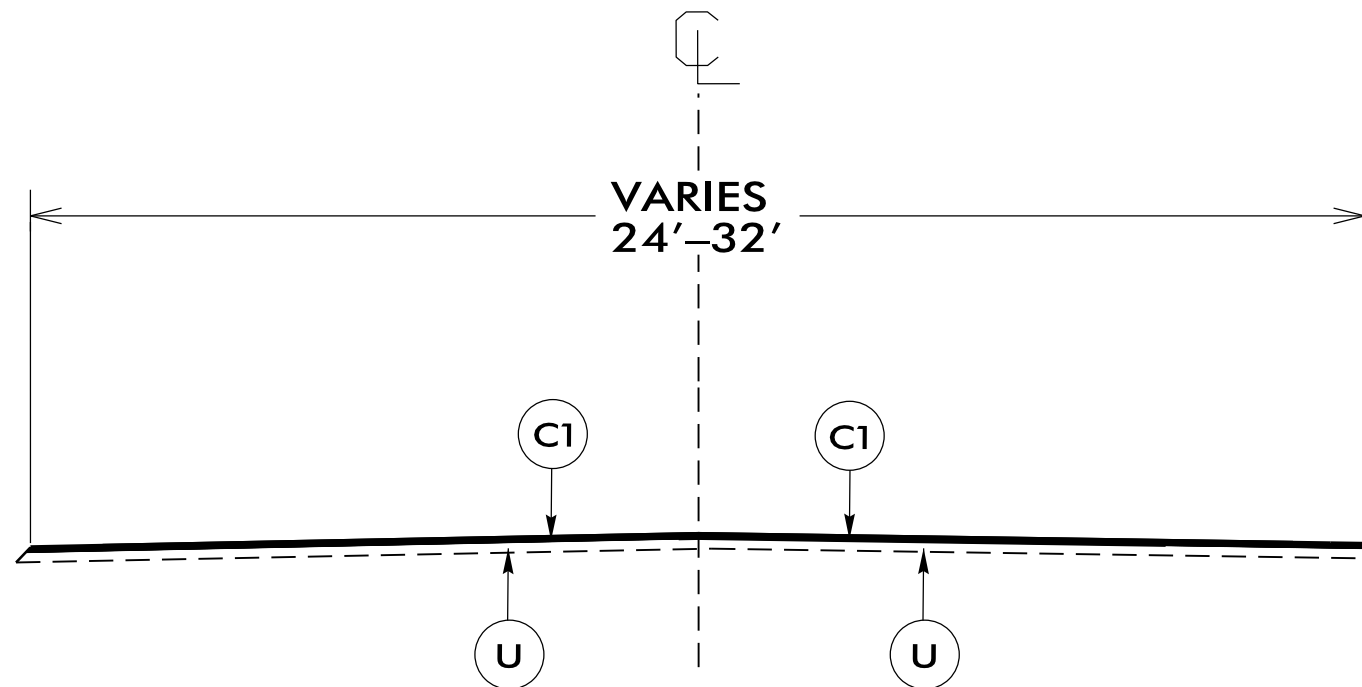

TYPICAL SECTION NO.1

USE WITH MAP 1,3

NTS

PAVEMENT SCHEDULE

C1	PROP. APPROX. 1.5" ASPHALT CONCRETE SURFACE COURSE, TYPE S9.5B, AT AN AVERAGE RATE OF 168 LBS. PER SQ. YD.
U	EXISTING PAVEMENT.

PROJECT REFERENCE NO.	SHEET NO.
1CR.10721.6 , ETC.	5

NOTES:

- *ALL PAVED S.R. ROADS TO BE RESURFACED TO THE ENDS OF THE RADI., OR AS DIRECTED BY THE ENGINEER
- *EDGES, PAVEMENT WIDENING, INTERSECTIONS, AND BRIDGE FLARES ARE INCLUDED IN THE TABLE OF QUANTITIES
- *PAVEMENT EDGE SLOPES ARE 1:1 UNLESS SHOWN OTHERWISE
- *SHOULDERS TO BE RECONSTRUCTED BY OTHERS

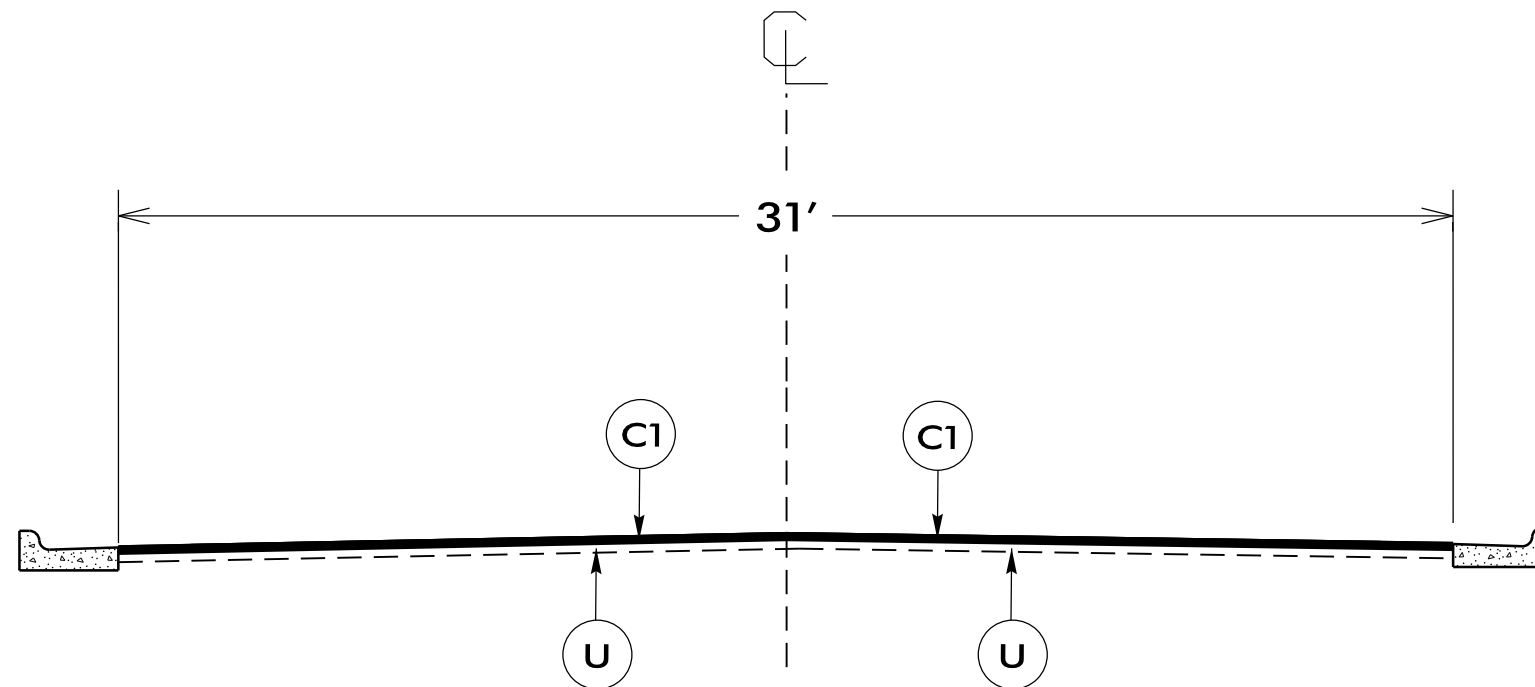

TYPICAL SECTION NO.2

USE WITH MAP 2

NTS

P A V E M E N T S C H E D U L E

C2	PROP. APPROX. 1½" ASPHALT CONCRETE SURFACE COURSE, TYPE SF9.5A, AT AN AVERAGE RATE OF 165 LBS. PER SQ. YD.
U	EXISTING PAVEMENT.

PROJECT REFERENCE NO.	SHEET NO.
1CR.10721.6 , ETC.	6

NOTES:

- *ALL PAVED S.R. ROADS TO BE RESURFACED TO THE ENDS OF THE RADI.,
OR AS DIRECTED BY THE ENGINEER
- *EDGES, PAVEMENT WIDENING, INTERSECTIONS, AND BRIDGE FLARES ARE
INCLUDED IN THE TABLE OF QUANTITIES
- *PAVEMENT EDGE SLOPES ARE 1:1 UNLESS SHOWN OTHERWISE
- *SHOULDERS TO BE RECONSTRUCTED BY OTHERS

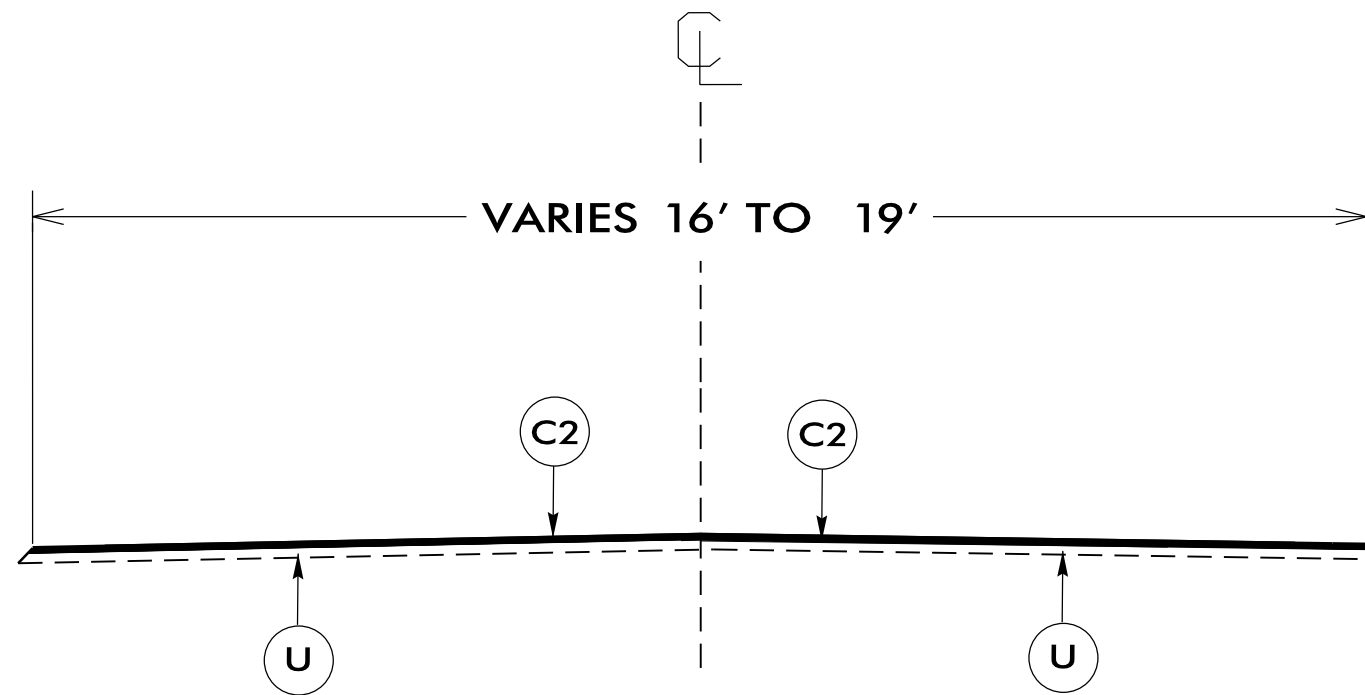

TYPICAL SECTION NO.3

USE WITH MAP 4,5,8,9,10

NTS

P A V E M E N T S C H E D U L E

C2	PROP. APPROX. 1½" ASPHALT CONCRETE SURFACE COURSE, TYPE SF9.5A, AT AN AVERAGE RATE OF 165 LBS. PER SQ. YD.
C3	PROP. APPROX. 1" ASPHALT CONCRETE SURFACE COURSE, TYPE S4.75A, AT AN AVERAGE RATE OF 100 LBS. PER SQ. YD.
U	EXISTING PAVEMENT.

NOTES:

- *ALL PAVED S.R. ROADS TO BE RESURFACED TO THE ENDS OF THE RADI., OR AS DIRECTED BY THE ENGINEER
- *EDGES, PAVEMENT WIDENING, INTERSECTIONS, AND BRIDGE FLARES ARE INCLUDED IN THE TABLE OF QUANTITIES
- *PAVEMENT EDGE SLOPES ARE 1:1 UNLESS SHOWN OTHERWISE
- *SHOULDERS TO BE RECONSTRUCTED BY OTHERS

PROJECT REFERENCE NO.	SHEET NO.
1CR.10721.6 , ETC.	7

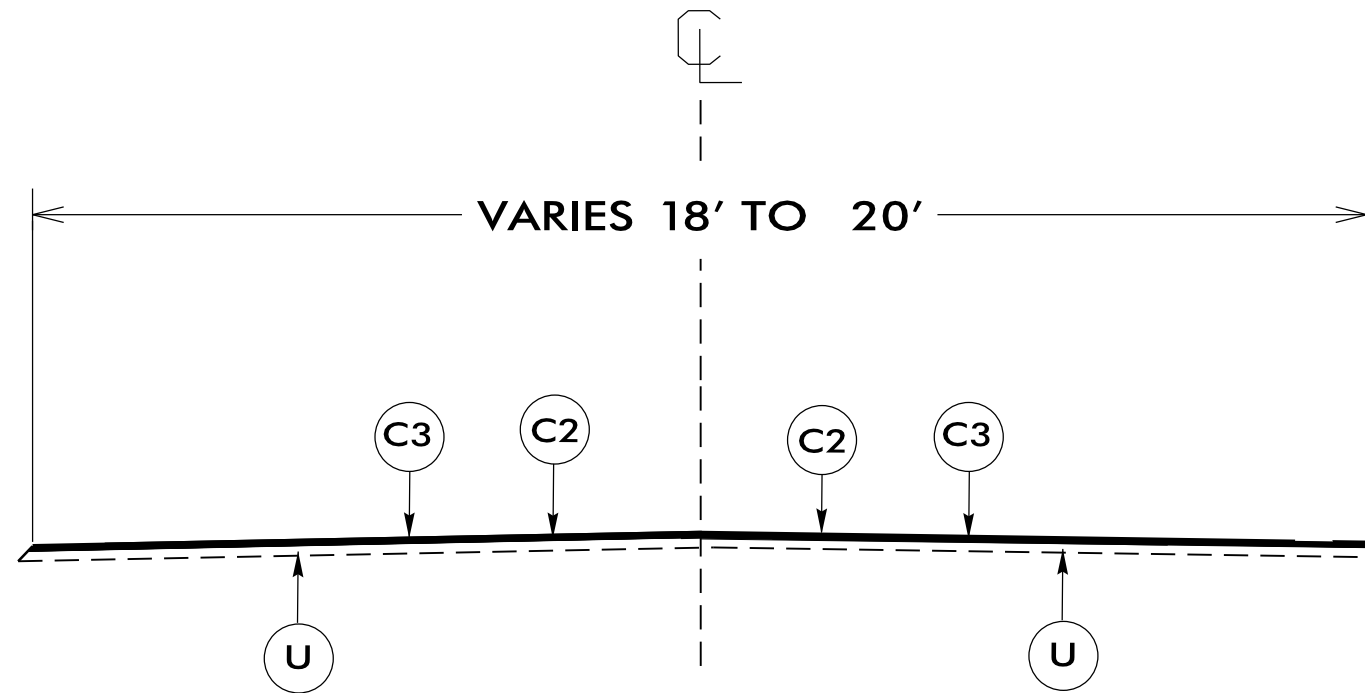

TYPICAL SECTION NO.4

USE WITH MAP 6,7

NTS

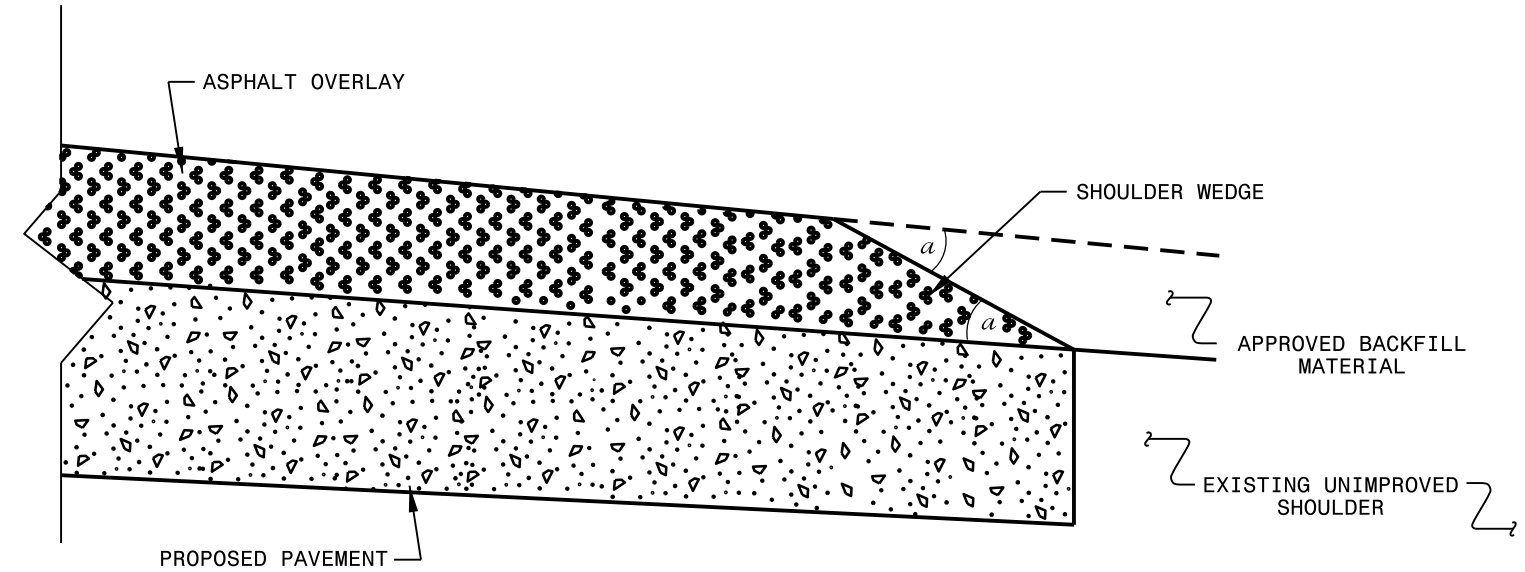

SHOULDER WEDGE DETAIL

(Resurfacing Projects w/ Widening or with Existing Paved Shoulder > 2 ft.)

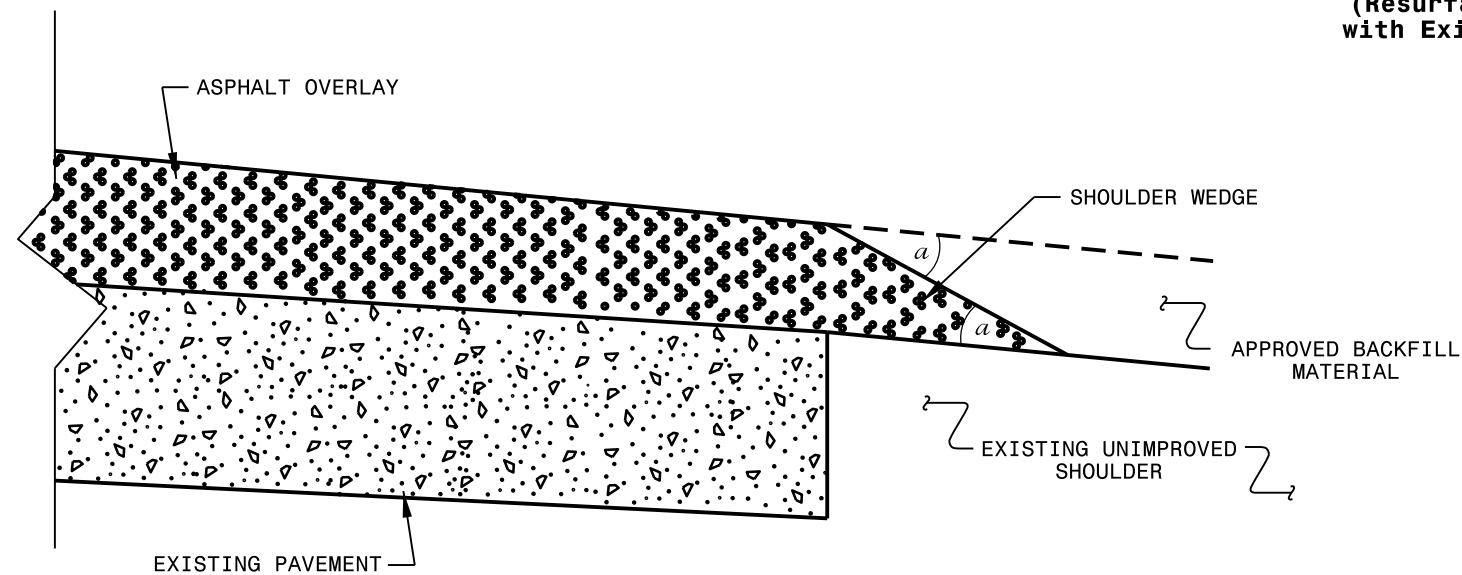

SHOULDER WEDGE DETAIL

(Resurfacing Projects w/ NO Widening)

NOTES:

- 1) DETAIL DOES NOT APPLY TO OGAFB AND ULTRA-THIN BONDED WEARING COURSE.
- 2) BACKFILL SHOULDER WITH APPROVED MATERIAL.
- 3) THE SHOULDER WEDGE DEVICE MAY BE DISENGAGED AT PAVED DRIVEWAYS AND SIDE STREETS.

a - SHOULDER WEDGE ANGLE = 30°

CONTRACT STANDARDS AND DEVELOPMENT UNIT	
Office 919-707-6950 FAX 919-250-4119	
SHOULDER WEDGE DETAILS	
ORIGINAL BY: T.SPELL	DATE: 7-19-11
MODIFIED BY:	DATE: 10/16/12
CHECKED BY:	DATE:
FILE SPEC.: susr/details/stand/shoulderwedgedetail.dgn	

SIGNING FOR RESURFACING PROJECTS

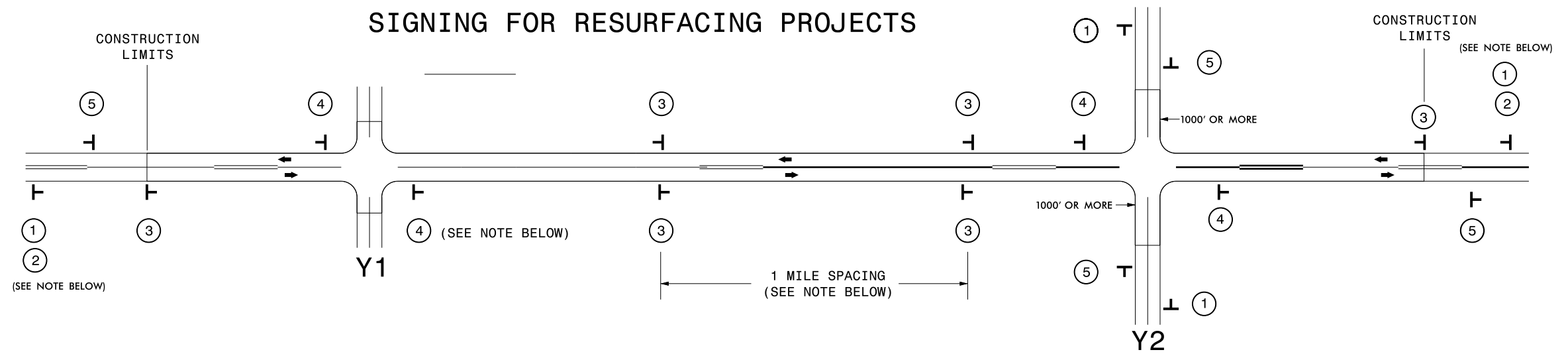

LEGEND	
	STATIONARY SIGN
	DIRECTION OF TRAFFIC FLOW

MAINLINE (-L-) SIGNING

-Y- LINE SIGNING

SIGNING NOTES AND PLACEMENT PER DIRECTION	MAINLINE (-L-) SIGNING		-Y- LINE SIGNING		
	① ②	 	<p>PLACE 1000' PRIOR TO BEGINNING OF CONSTRUCTION LIMITS. ONLY USED ON -Y- LINES IF RESURFACING LIMITS EXTEND 1000' ALONG -Y- LINE.</p> <p>#2 SIGN ONLY USED WHEN RESURFACING LIMITS ARE 2 OR MORE MILES IN LENGTH. ROUND UP TO NEXT WHOLE NUMBER. (NO FRACTIONAL OR DECIMAL NUMBERS)</p>	<p>NO REQUIRED STATIONARY SIGNING FOR THE FOLLOWING -Y- LINE CONDITIONS:</p> <ol style="list-style-type: none"> LESS THAN 1000' OF RESURFACING ALONG -Y- LINE SUBDIVISION ROADS DEAD END ROADS 	
	③		<p>PLACE INITIALLY AT THE CONSTRUCTION LIMITS AND SPACED 1 MILE APART THEREAFTER. IF NO -Y- LINES EXIST, PLACE 2ND SET 1/2 MILE FROM THE CONSTRUCTION LIMITS AND THEN SPACE 1 MILE THEREAFTER.</p>	<p>WHEN PAVING/CONSTRUCTION ACTIVITIES PROCEED ACROSS AN UNSIGNED -Y- LINE, ADVANCE WARNING PORTABLE SIGNS SHALL BE USED ALONG THE -Y- LINE AS SHOWN BELOW. REMOVE UPON COMPLETION OF WORK.</p>	
	④		<p>THESE ARE FOR -Y- LINES THAT ARE "THROUGH" ROADWAYS. DEAD END AND SUBDIVISION ROADS ARE NOT "THROUGH" ROADWAYS. INSTALL 500' +/- FROM EACH -Y- LINE APPROACH AS SHOWN ABOVE. FOR MULTIPLE -Y- LINES THAT ARE SEPARATED BY 0.25 MILES OR LESS, TREAT AS A SINGLE UNIT AND INSTALL WITHIN 500' OF EACH APPROACH. A MAXIMUM OF 2 SIGN SETS PER MILE. DO NOT INSTALL WHEN -Y- LINES ARE WITHIN 0.5 MILES FROM "END ROAD WORK" SIGN.</p>	 	<p>PLACED 500' IN ADVANCE OF FLAGGER. PLACED 250' IN ADVANCE OF FLAGGER.</p>
	⑤		<p>PLACE 500' FOLLOWING THE END OF CONSTRUCTION LIMITS.</p>		

25-NOV-2013 08:45
E:\District11\Projects\2013\Perquimans\Plans\006.LS.dwg - pavemop.dwg
DWGSS - AT - DICAD264931

**RESURFACING
ADVANCE WARNING SIGNS
FOR
RURAL AND SUBURBAN
2 LANE ROADWAYS**

PROJECT NO.	SHEET NO.	TOTAL NO.
1CR.10721.6, ETC.	10	10

SUMMARY OF QUANTITIES

PROJECT NO	COUNTY	MAP NO	ROUTE	DESCRIPTION	TYP NO	LANES	LANE TYPE	FINAL SURFACE TESTING REQUIRED	WARM MIX ASPHALT REQUIRED	LENGTH MI	WIDTH FT	MOBILIZATION LS	INCIDENTAL STONE BASE TONS	SURFACE COURSE, S9.5B TONS	SURFACE COURSE, SF9.5A TONS	SURFACE COURSE, S4.75A TONS	ASPHALT BINDER FOR PLANT MIX TONS	ADJ. OF METER OR VALVE BOX EA
1CR.10721.6	Perquimans	1	NC 37	US 17 BUSINESS TO WINFALL	1	2	2WU	NO	NO	1.33	32	1	10	2,356			141	
1CR.10721.7	Perquimans	2	NC 37	FROM BEGIN OF C & G TO END OF C & G	2	2	2WU	NO	NO	0.59	31	*	2	1,005			60	
1CR.10721.8	Perquimans	3	NC 37	FROM END OF C&G TO CHOWAN COUNTY LINE	1	2	2WU	NO	NO	8.23	24	*	140	9,940			596	
1CR.20721.29	Perquimans	4	SR1334 HOG NECK RD	SR 1329 WOODVILLE RD TO SR 1365 LEE WILSON RD	3	2	2WU	NO	NO	1.35	19	*	5		1,250		84	
1CR.20721.32	Perquimans	5	SR 1339 PENDER RD	FROM SR 1336 HARVEY POINT ROAD TO SR 1340 SNUG HARBOR RD	3	2	2WU	NO	NO	4.25	18.5	*	80		3,906		262	
1CR.20721.33	Perquimans	6	SR1341 BURNT MILL RD	FROM SR 1340 SNUG HARBOR RD TO SR 1342 PERRY LONG ROAD	4	2	2WU	NO	NO	0.59	18.5	*	5		542	338	59	
1CR.20721.34	Perquimans	7	SR 1356 BETHEL FISHING CENTER RD	FROM SR 1340 TO END OF MAINTENANCE	4	2	2WU	NO	NO	0.31	20	*	5		302	192	33	1
1CR.20721.35	Perquimans	8	SR 1370 OLIVER ROAD	FROM SR 1356 TO SR 1415	3	2	2WU	NO	NO	0.50	16	*	2		405		27	
1CR.20721.36	Perquimans	9	SR 1415 HAPPY LN	FROM SR 1370 TO DEAD END	3	2	2WU	NO	NO	0.07	16	*	1		70		5	
1CR.20721.37	Perquimans	10	SR 1412 GOOSIE LN	FROM SR 1370 TO SR 1370	3	2	2WU	NO	NO	0.24	18	*	2		221		15	
GRAND TOTAL										17.46		1	252	13,301	6,696	530	1,282	1

THERMOPLASTIC AND PAINT QUANTITIES

PROJECT NO	COUNTY	MAP NO	ROUTE	DESCRIPTION	TYP NO	LANES	LANE TYPE	LENGTH	WIDTH	TEMPORARY TRAFFIC CONTROL LS	WORK ZONE SIGNS (STATIONARY) SF	4" WHITE PAINT LF	4" YELLOW PAINT LF	24" WHITE PAINT LF	PAINT MSG SCHOOL EA
1CR.10721.6	Perquimans	1	NC 37	US 17 BUSINESS TO WINFALL	1	2	2WU	1.33	32	1	80	140,000	9,160		
1CR.10721.7	Perquimans	2	NC 37	FROM BEGIN OF C & G TO END OF C & G	2	2	2WU	0.59	31	*	80		6,000		
1CR.10721.8	Perquimans	3	NC 37	FROM END OF C&G TO CHOWAN COUNTY LINE	1	2	2WU	8.23	24	*	470	88,555	54,318	600	12
1CR.20721.29	Perquimans	4	SR1334 HOG NECK RD	SR 1329 WOODVILLE RD TO SR 1365 LEE WILSON RD	3	2	2WU	1.35	19	*		14,000	8,000		
1CR.20721.32	Perquimans	5	SR 1339 PENDER RD	FROM SR 1336 HARVEY POINT ROAD TO SR 1340 SNUG HARBOR RD	3	2	2WU	4.25	18.5	*		45,000	28,000		
1CR.20721.33	Perquimans	6	SR1341 BURNT MILL RD	FROM SR 1340 SNUG HARBOR RD TO SR 1342 PERRY LONG ROAD	4	2	2WU	0.59	18.5	*		6,000	3,500		
1CR.20721.34	Perquimans	7	SR 1356 BETHEL FISHING CENTER RD	FROM SR 1340 TO END OF MAINTENANCE	4	2	2WU	0.31	20	*					
1CR.20721.35	Perquimans	8	SR 1370 OLIVER ROAD	FROM SR 1356 TO SR 1356	3	2	2WU	0.5	16	*					
1CR.20721.36	Perquimans	9	SR 1415 HAPPY LN	FROM SR 1370 TO DEAD END	3	2	2WU	0.07	16	*					
1CR.20721.37	Perquimans	10	SR 1412 GOOSIE LN	FROM SR 1370 TO SR 1370	3	2	2WU	0.24	18	*					
GRAND TOTAL								17.46		1	630	293,555	108,978	600	12
												402,533			